

# STANTONBURY PARISH NEWS

**Stantonbury  
Parish Council Budget  
for 2018**

*page 4-5*

**Important information  
about parking in  
the Parish**

*page 7*

**Bradwell Windmill  
open days  
for 2018**

*page 17*



**FREE to residents of  
Stantonbury Parish**

126 Kingsfold, Bradville  
Milton Keynes  
MK13 7DX

**w:** [stantonbury-pc.org.uk](http://stantonbury-pc.org.uk)  
**e:** [info@stantonburyparishcouncil.org.uk](mailto:info@stantonburyparishcouncil.org.uk)  
**t:** 01908 227 201



## CHAIRMAN'S REMARKS

### Welcome to this year's first edition of the Parish Newsletter.

With an ever-increasing workload within the Parish Office as a consequence of devolved services, the neighbourhood plan and regeneration we have had to step back and look at the workload of the staff and the way the Parish Council administers its responsibilities.

Parishioners may not be aware that the Parish is run, with the exception of the Parish Ranger, by a wholly part-time work force.

Our Clerk currently has three roles: That of the Clerk and the Responsible Financial Officer and the management of the office. After an analysis of her needs it has been agreed by the Council and the Clerk to restructure the office internal activities.

Commencing in February 2018 the Parish Office will be split into two overlapping responsibility areas. The Clerk remains as the overall statutory official within the Council and will report to the Chair and other councillors in respect of financial and council business.

A new post of Office Manager has been created with all remaining functions of the Parish Office falling under the office manager. I'm pleased to report that Mrs Helen Sharp will commence work with the Parish in mid-February and she will report to the Chair of the Management Committee.

I'm also pleased to report that the draft Neighbourhood Plan is complete and available for review on the Parish website. It's important that parishioners fully understand the implications and ramifications of the Plan and its associated action plan. We are about to enter into public consultation and every household has been provided with a leaflet pointing out dates and venues.

Devolved Services remains a difficult area of negotiation. Milton Keynes Council have put forward a Draft Framework Agreement whereby they have put forward options for Parish Councils to consider. This agreement has not been formally issued but MK Council want Parishes to sign up to it by May 2018. There are a number of options and the Council will consider the merits of each. In

the meantime the Parish Ranger will respond to any landscaping questions you may have and undertake minor works.

In this edition you will find further comment on parking on green spaces. We are working with Milton Keynes Council to stop this practice which is essentially undertaken by a few irresponsible drivers. We request that parishioners park sensibly and stop the considerable damage that is now occurring.

Finally, for some time we have not had Councillors representing Oakridge Park and for a lesser time Bancroft. If you feel that you want to help in supporting the community as a Parish Councillor please contact the Parish Clerk.



## REGENERATION UPDATE FROM YourMK

In April 2018 YourMK will start working with all residents in North Bradville to develop the regeneration plan. North Bradville consists of 5 streets. These are Crispin Road, Harrowden, Kingsfold, Minstrel Court and Woodstock Court.

We will write to every resident in April before any engagement starts, so that you know the key information, dates and contact details. We want you to be involved in helping create the plan for North Bradville that addresses key issues.

It is important for you to tell us what is important to you and what you would like to see happen.

We will work closely with the Parish Council to make sure that the decisions and views from the Neighbourhood Plan feed into plans for regeneration.

Regeneration is not just about physical changes. We will also be providing support to find jobs, access training and develop projects with residents that address important factors within

the community.

If you would like to speak to us before April, you can do so in the following ways:

- We are available every Monday at the Parish Council offices, on Kingsfold, from 9am-12pm
- You can follow us on Facebook or Twitter (search for "YourMK").
- Go on our website [www.yourmk.co.uk](http://www.yourmk.co.uk)
- Call us on 01908 991570.
- Email us at [regeneration@yourmk.co.uk](mailto:regeneration@yourmk.co.uk)

# STANTONBURY PARISH COUNCIL NEEDS YOUR HELP TO HELP US

## #Rubbish #Graffiti #Landscaping #Abandoned Vehicles

We are working hard to keep the Stantonbury Parish clean from graffiti and rubbish and landscaping issues. We would like you to be our eyes around the Parish.

### Tell us about

- Minor graffiti
- Damaged play park equipment.
- Where the overgrown shrubs are encroaching the public footpaths
- Street lighting out
- Street signs damaged
- Inform us of speeding issues within the estates
- Car parking / verge damage
- Green space vandalism (including parking damage)
- Dog bin vandalism

### Useful websites, emails, addresses and numbers

#### Stantonbury Parish Office

126 Kingsfold, Bradville, MK13 7DX

Parish report line - 01908 322239

email: [info@stantonburyparishcouncil.org.uk](mailto:info@stantonburyparishcouncil.org.uk) website:

[www.stantonbury-pc.org.uk](http://www.stantonbury-pc.org.uk)

#### MK Council

01908 691691

Email: [envservices@milton-keynes.gov.uk](mailto:envservices@milton-keynes.gov.uk)

website: [www.mycouncil.milton-keynes.gov.uk](http://www.mycouncil.milton-keynes.gov.uk)

#### New Bradwell Recycling Centre

01908 315111

Newport Road, New Bradwell, MK13 0AH

Help us by reporting to MK Council the following issues:

- Dumped rubbish and household items so it can be collected
- Abandoned vehicles
- Street lighting out
- Street signs damaged
- Missing drain covers
- Potholes
- Obscene graffiti
- Fly tipping

Our Ranger will be out and about recording all of the above issues and where possible dealing with them. With such a large area for one person to cover the more you help us the more we can achieve.

If we don't know about it we cannot do anything to help. Our aim is for our Parish to be a clean, tidy and nice safe place to live and be proud of for everyone.

**Help us where you can!**



We always welcome articles and community notices for inclusion in this newsletter, and items of local interest, old photographs, etc.

For submission deadlines please contact the Parish Office on **01908 227 201**

Or email: [info@stantonburyparishcouncil.org.uk](mailto:info@stantonburyparishcouncil.org.uk)

Handwritten items can be accepted and photographs could be scanned by the Parish Office. Stantonbury Parish Council reserves the right to edit, defer or refuse articles and advertising submitted for publication.



## STANTONBURY PARISH COUNCIL BUDGET

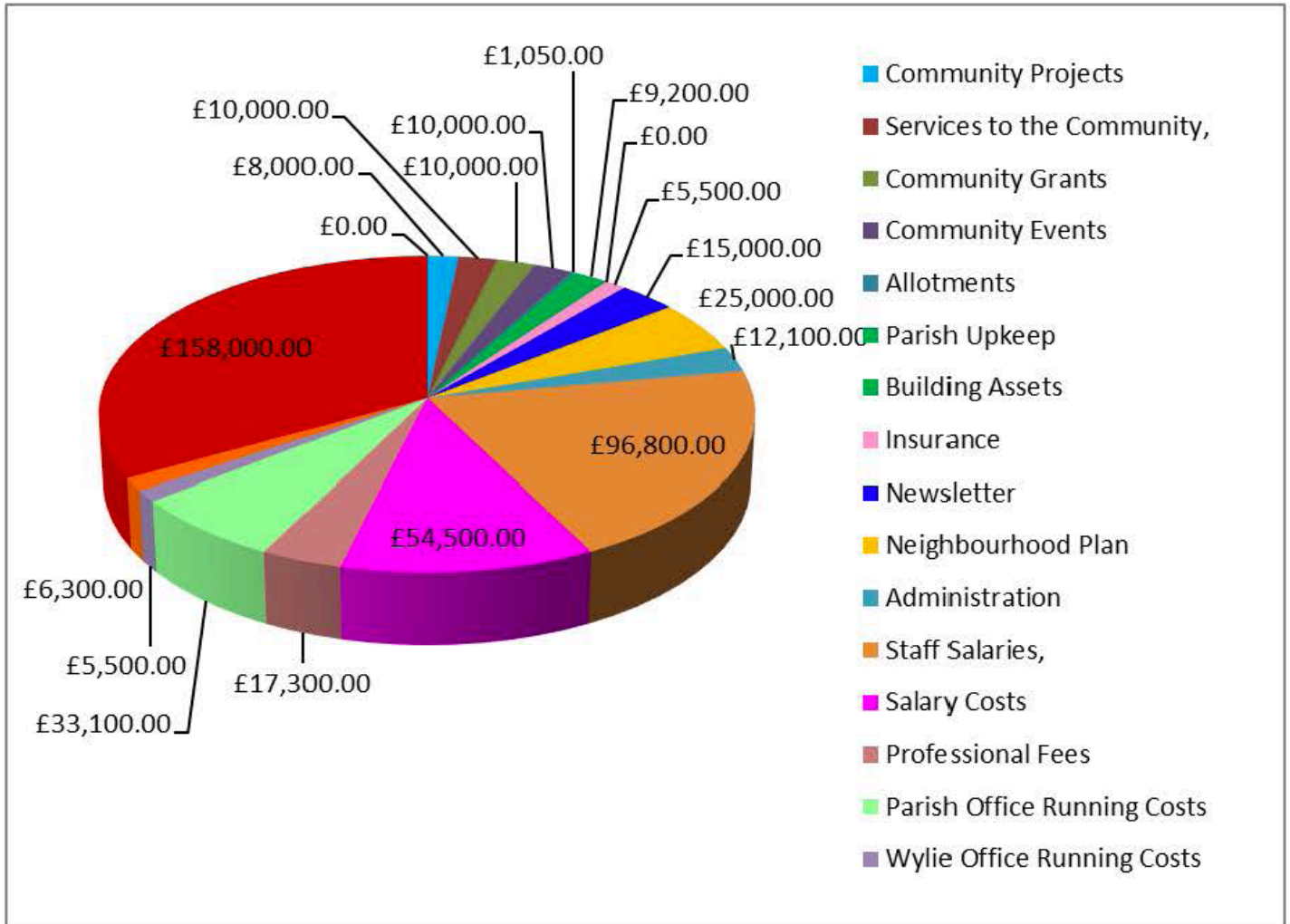

The Parish Council is first tier Local Government and was formed for the purpose of representing the residents of Bancroft, Bancroft Park, Blue Bridge, Bradville, Linford Wood, Oakridge Park, Stantonbury and Stantonbury Fields.

The Parish Council raises a local tax (the precept) which is paid to us by Milton Keynes Council and collected via the Council Tax. The precept is

then spent within the Parish and all expenditure is approved by Councillors who are local, unpaid residents who have been elected on by you every four years. The next elections will be held in May 2019.

We hold our main council meetings the 1st and 3rd Wednesdays of each month and these are open to all members of the public.



## STANTONBURY PARISH COUNCIL BUDGET

| <b>Stantonbury Parish Council Budget 2018/2019</b>   |                      |
|--|----------------------|
| <b>EXPENDITURE</b>   | £                    |
| Community Projects Including Coach trips, Football School, Play dates  | £ 8,000.00           |
| Services to the Community, Citizen Advice Bureau, ESOL, Job Clubs  | £ 10,000.00          |
| Community Grants   | £ 10,000.00          |
| Community Events   | £ 10,000.00          |
| Allotments   | £ 1,050.00           |
| Parish Upkeep including dog bins, CCTV costs   | £ 9,200.00           |
| Building Assets major maintenance, refurb costs  | £ , 0.00             |
| Insurance  | £ 5,500.00           |
| Newsletter   | £ 15,000.00          |
| Administration Photocopier, Postage, website etc.  | £ 12,100.00          |
| Staff Salaries,  | £ 96,800.00          |
| Salary Costs Pensions, Pension Deficit, NI   | £ 54,500.00          |
| Professional Fees Audit, Legal, Subscriptions, Bank Charges, Training  | £ 17,300.00          |
| Parish Office Running Costs Utilities, Security, Water, Gas, Telephone, Cleaning, Insurance, Maintenance and minor expenditure | £ 33,100.00          |
| Wylie Office Running Costs, Utilise, Security, Water, Gas, Telephone   | £ 5,500.00           |
| Councillor Allowances  | £ 6,300.00           |
| Neighbourhood Plan   | £ 25,000.00          |
| Devolved Service   | £ 158,000.00         |
| Contribution to reserves   | £ <b>--63,981.00</b> |
| <b>INCOME</b>  |                      |
| Reserves   | £ 63,981.00          |
| VAT Refund   | £ 7,000.00           |
| Grant Funding  | £ 3,100.00           |
| Allotment Income   | £ 950.00             |
| Milton Keynes Council Grant Income   | £ 24,217.10          |
| <b>PRECEPT</b>   | <b>£378,101.90</b>   |

Stantonbury Parish Council have raised the precept this year.

Band D properties will increase by £16.37 per year. This is a weekly increase of £0.31. This will be less for bands A-C.

As detailed last year we are continuing to invest in devolved services and you may have noticed our new ranger and his van around the Parish. There is a separate article in the newsletter.

The Councillors and staff of SPC would like to thank you for your continued support.





## CRIME PREVENTION ADVICE - THEFTS FROM VEHICLES

Thefts from insecure vehicles have recently seen an increase in this area. There are some simple steps you can take to make yourself less likely to be a victim. There is also a leaflet you can download which gives you useful advice you can that can be used in conjunction with the information listed below.

### Lock doors and close windows

A vehicle left unlocked or with windows open is an invitation to a thief and some criminals will simply keep checking vehicles until they find one unlocked, so don't leave your vehicle insecure, physically check that your doors and windows are locked.

### Remove all items from the vehicle

Most criminals are opportunists - they take what they can, when they see it. If a vehicle looks empty, the chances are they may leave it alone.

Don't make life easy for criminals by leaving any items on display. Either take your property with you when you get out of the vehicle or keep items locked in the boot out of sight. Even things like an old coat, sunglasses or loose change can be a temptation for someone to 'smash and grab' - they steal first and think about value later.

**To help to try and prevent other thefts and to ensure that your car is not an appealing target for a thief, we are asking you to be extra vigilant and consider your vehicle security.**

- Look out for your neighbours when they are not home. If you see anything suspicious report it to the police and inform your neighbour.
- Ensure your car is always left locked and secure.
- Do not leave possessions in your car, whether valuable or not. A thief wouldn't know the bag left on the back seat only contains a gym kit for example.

- If you have a portable Sat Nav remove it when not in use and also remove the cradle and wipe off any sucker marks as they are an indicator that the Sat Nav itself may still be in the car. A criminal will happily smash a window to check!

Register your Sat Nav and any other electrical items on Immobilise, the UK National Property Register, free of charge at [www.immobilise.com](http://www.immobilise.com)

Leave your empty glove box and centre console open so that it can be seen that there is nothing to steal.

If you have a garage - use it! Always lock the garage and the vehicle. If you don't have a garage always try to park in a well lit open place in public view.

If possible use secure car parks displaying the Park Mark™ sign. For details on the Park Mark™ scheme go on line to [www.parkmark.co.uk](http://www.parkmark.co.uk)

For further advice and information on securing your vehicle visit the Thames Valley Police web site at [www.thamesvalley.police.uk](http://www.thamesvalley.police.uk)

### Set up a Neighbourhood Watch Scheme in your area

Would you like to bring your community closer together, or do you have concerns about burglary, antisocial behaviour or the general environment in your street?

Through Neighbourhood Watch you can help the Police and your neighbours to strengthen your community. You can make your area a better place to live. The scheme is free to join.

Consider setting up a NHW Scheme in your area, for more information email [david.huckle@thamesvalley.pnn.police.uk](mailto:david.huckle@thamesvalley.pnn.police.uk)

## PARKING IN THE PARISH



**In the summer of 2016 the Parish Newsletter contained an article regarding Parking in the Parish. In the winter of 2016 we undertook a campaign notifying those residents that had parked on amenity grass and damaged the grass areas.**

I would like to update parishioners with respect to Parking around the Parish.

The campaign was by and large very successful and car drivers did stop parking on and damaging the grass. In 2017 we, after talking to Milton Keynes Council, held back from the campaign and sadly the irresponsible few have again started and continue to park indiscriminately on our amenity areas. This included commercial vehicles accessing the estate roads. The damage this year is extensive and as we move toward taking over these green spaces the cost of reinstatement will be passed on to all the parishioners.

The Neighbourhood Plan questionnaire response was quite emphatic on two subjects, Parking and Protection of the amenity spaces. We are looking at both to see what can be achieved. However it is not the Parish Council's intention to sacrifice the green amenity spaces for what is just convenience of car drivers. There has to be a sensible discussion on both issues. After the Neighbourhood Plan referendum, if

approved, we will engage with the community on a road by road basis to see what can be done.

In the mean time we will, in conjunction with Milton Keynes Council, recommence the campaign to stop parking on the amenity grass by cars and commercial vehicles. We will be posting letters to all the adjacent houses where it occurs, identifying the car registrations and notifying all the residents of the action that Milton Keynes Council can/ intends to take. Fines are an option. This process has commenced in Stantonbury and Bradville and apart from three disgruntled residents the majority of drivers have cooperated with us.

It's not just a question of ruts in the grass. In the photos above fire appliances had to attend a serious house fire in Crosslands Stantonbury (3 Feb 2018). As you can see the main hose connection is in the green space as they are in many parts of the Parish. The indicator stump for its location had been destroyed by parked cars and finding the outlet caused delays in fighting the fire. In many places the indicator stumps have been knocked over by cars parking on the grass. It could be your home on fire next time.

We would like to thank all the residents that continue to park responsibly.



**So 2017 has been another very successful year for the group even though we did have a few members move out of the area. We managed to get funding from Safer MK to pay for our insurance cover, giving us another year to “Make a Difference” to our Communities.**

Through our link with MK Enviromental Servicies we have reported many things such as graffiti, fly tipping, damage by vandals and overgrown vegetation. On Valentines Day we arranged a “Pop Up Event” for Oakridge Park and were joined by Christ Church, a Parks Trust Ranger, Fun Fridays, Save St. Peters, Community Action, Bradville Hall, TVP & OPRA. It was very nice to see the residents come along for a chat and some special activities for the children.

Our members have been out cutting back bushes that have overgrown onto the footpaths.

Dumped newspapers have been an issue on Bradville and again our members have been out removing them.

### **Contact us via**

Email: **action-4@outlook.com**

Tel: **01908 316 938**

Bancroft, Bancroft Park, Blue Bridge,  
Bradville, Oakridge Park & Stantonbury

Dog poo spraying has been carried out by our local dogwalkers highlighting areas where there are problems such as Bradvue Crescent. A need for a Poo Bin had been identified and so the Parish Council installed one.

Many residents reported to MKC that the lights were out at the Marlborough Street roundabout but nothing was done. So we contacted our Ward Councillor Alex Walker who managed after just a few days to get them put back on.

We have continued with our Consultation focusing this time on Oakridge Park and the “3 B’s”. We have been awarded a grant of £100.00 from WH Smith which will go towards our 2018 insurance cover. We would also welcome a few more members; so please volunteer and help us bring back a bit of “Caring for our Communities”.

Thank you to everyone who has helped over the year.

## **LITTER PICK ON STANTONBURY**

Action 4 Your Community would like to invite you for an organised litter pick around the area of Stantonbury. No previous experience necessary.

We will meet at the shops on Saturday 7<sup>th</sup> April at 10:30.

Litter pickers and refuse bags will be provided but if you have your own please bring them.

Come along for an hour or two of exercise and help make a difference to your neighbourhood. All welcome.

Refreshment will be provided.





## **Easter 2018 CHILDRENS' EVENT**

Funded and organised by Stantonbury Parish Council

### **Football in the park**

#### **FREE EVENT**

##### **Cawarden Park, Stantonbury**

(with 2 football coaches) on the following dates:

**Wednesday 28th March 2018 from 1.00.to 3.30.pm**

**Wednesday 4th April 2018 from 1.00 to 3.30.pm**

**Children aged under 5 years - 1.00.pm – 1.30.pm**

**Children aged 6 upwards - 1.30.pm – 3.30.pm**



## **EASTER SCHOOL HOLIDAYS**

**Calling all Boys and Girls aged 3 years to 16 years**

### **MK Dons S.E.T. will be offering Multi-Sports sessions - FREE**

At the Play Area between Harrowden and Crispin Road, Bradville

**On Tuesday 27th March 2018**

**And Tuesday 3rd April 2018**

**From 1.00pm to 3.00pm**

**PLEASE COME ALONG AND JOIN US!**



# BURY ST EDMUNDS

## Day Trip for Over 60's

**Wednesday 13th June 2018 leaving  
Stantonbury Parish Office at 8.30.am  
(please arrive by 8.15am).**

**Leaving Bury St Edmunds @ 16.30pm.  
£5-00 per seat**

Tickets will be on sale from Stantonbury Parish  
Office on Tuesday 1st May 2018 from 10.00.am

PLEASE NOTE: No refunds after Wednesday 6th June 2018  
No reserving of tickets (First come / First serve basis)  
Ticket number is not seat allocation number  
Open to Stantonbury Parish residents only

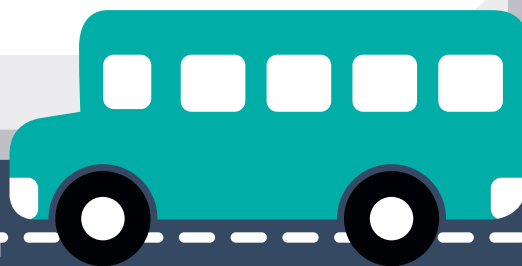

# Coach trip to SOUTHEND ON SEA



**Wednesday 22nd August 2018**

**The coach will leave at 8.30am prompt from  
Stantonbury Parish Office, 126 Kingsfold,  
BRADVILLE MK13 7DX**

**£5-00 per person (living in Parish)**

**£10 per person (out of area)**

Please Note: 1) Tickets will be on sale every weekday from Tuesday  
3rd July 2018 from 9.00am to 3.30pm

2) No refunds after Tuesday 15th August 2018

3) No reserving of seats (first come / first served basis)

4) Ticket number is not seat allocation number

5) All names must live within the Parish of Stantonbury





## OAKRIDGE PARK POST BOX



**Residents on Oakridge Park were overjoyed to finally see the installation of a Royal Mail post box located on Selkirk Drive.**

This issue was raised when Community Action's MK's Development Officer Allison Carlton met with residents back in May last year. After discussions with Royal Mail, the property developers and utility companies, plans were put in place to establish the best location for the Post Box. Sadly it missed the

Christmas rush but was in place in early January. Residents commented, "After 8 1/2 years this calls for a street party celebration, and "very much appreciated, thanks everyone."

This has had a positive impact on the local community and has saved the drive to the nearest post box in Stantonbury. Local children will have the opportunity to celebrate its installation by entering into a local art and design competition with a chance to win some commemorative stamps, kindly donated by Royal Mail.

## WINDOWS AND WIND TURBINES

While most birds are good at flying around natural obstacles, some are breathtaking, such as the goshawk and tawny owl in woodland. However even masters such as these, with their finely tuned senses and body shapes, benefit through close mental mapping of their territories. However, when it comes to dealing with man-made structures which often deceive the eye, even these avian Red Arrows can be thwarted, and over several centuries wild birds have been inadvertently killed in significant numbers.

The problem really started when plate glass windows became common place in the late 19th century, at the same time as the human population soared and buildings became higher. Since then the number of bird strikes on windows has increased dramatically, frequently leading to injury and death. Some birds collide in the heat of the chase but most do so because there is a reflection of the sky or trees in the glass, or there is another window in the room making birds think there is a way through. Thankfully, the problem has been somewhat solved through sticking tapes or

cut outs to the windows or even installing special glass which looks clear from the inside but solid from the outside but such deaths will always remain common.

Most recently the proliferation of wind turbines and wind farms has caused increasing worldwide concern as significant numbers of birds and even bats have flown into them and been killed leading to an outcry from some conservationists. Indeed, birds of prey as well as some water birds are among the species most frequently affected as they often share the wild and windy places where turbines are sited. It is encouraging to report that increasing research has been taking place to reduce the negative impact of this valuable renewable -energy source. In light of this the RSPB commented 'Climate change poses the single greatest long term threat to birds and other wildlife and recognises the essential role of renewable energy. In addressing this they strongly advocate strategic spatial planning at national, regional and local government scale, to help identify low impact locations for wind energy developments'.

# MILTON KEYNES MUSEUM

**SCRUMMY PRIZES**  
for  
observant children

Plus all of our usual fun exhibits

## Easter Egg Hunt

**Fri 30th March to Mon 2nd April 2018**

**Adults £9.00**

**Children £6.00**

**Concess £7.00**

**Families £26.00**

**Open**

**11.00am - 4.30pm**

**01908-316222 [www.mkmuseum.org.uk](http://www.mkmuseum.org.uk)**

**Milton Keynes Museum, McConnell Drive, MK12 5EL**



## EVENTS 2018

**Milton Keynes**  
**museum**  
2019: past, present, *future*

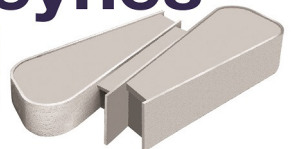

- |                                       |                              |
|---------------------------------------|------------------------------|
| • Easter Fun and Egg Hunt             | 30th March - 2nd April       |
| • Watford & District Classic Car Club | 22nd April                   |
| • History Festival                    | 12th - 13th May              |
| • Lawnmower Day                       | 20th May                     |
| • Look at Life                        | 26th - 27th May              |
| • Summer Half Term                    | 28th May- 1st June           |
| • Victorian Weekend                   | 23rd - 24th June             |
| • 1950s/1960s Weekend                 | 7th - 8th July               |
| • 1940s Weekend                       | 1st -2nd September           |
| • Heritage Open Days & Beer Festival  | 6th - 9th September          |
| • Transport Weekend                   | 15th - 16th September        |
| • Organ Festival                      | 6th - 7th October            |
| • Autumn Half Term                    | 29th October - 2nd November  |
| • Victorian Christmas                 | 30th November - 2nd December |
|                                       | 7th - 9th December           |
|                                       | 14th - 16th December         |
| • Napoleonic Re-enactors              | Date to be confirmed         |



## Mobile Foot Clinic

Treatments carried out in the comfort  
of your own home



- Nail Trimming
- Corns
- Verrucas
- Fungal Infections
- Ingrowing Toenails
- Hard Skin (Callus)
- Cracked Heels
- Diabetic Foot Care

**Mobile: 07704 732338**

**Email: [scfeet@outlook.com](mailto:scfeet@outlook.com)**



**Samantha Costello MCFHP MAFHP**

is a fully qualified and registered member of  
The British Association of Foot Health Professionals

## COUNCILLOR VACANCY

**We have two vacancies for  
Parish Councillors for Bancroft  
and Oakridge.**

If you feel you would like to get involved in making decisions about your local community, local issues and make a significant contribution to the area in which you live or work, then this is the position for you!

Do you have an interest in your local environment, local transport, local government finances, amenities, planning and housing issues, community events, anti-social behaviour and policing, and want to make a difference then please apply!

You must be aged 18 years and over, eligible to vote and have lived or worked in the Parish for 12 months or more, or within 3 miles of the Parish boundary.

First instance send an email or letter to the Parish Clerk (Mrs Helen Mortimer)

## PETANQUE

**Bancroft Park Petanque Club was formed in June 2001 as a sub group of Roman Park Residents Club and currently has over fifty members.**

Petanque, also known as Boule, is a very simple game, played on equal terms by men and women, young and old, on almost any surface in any weather.

The club plays on the piste, situated just below the Roman Park Residents Club premises, on Sundays at 11.00 am, Tuesdays and Thursdays at 2.00 pm.

Even if you have never played before you will be made most welcome to join in at the above times. Equipment and tuition can be supplied if required.

Social events and competitions are also arranged throughout the year.

For further details please either look at the notice board in the foyer of the club or email [bancroftparkpetanqueclub@gmail.com](mailto:bancroftparkpetanqueclub@gmail.com)







**You are very welcome to join us at**  
**Christ Church Community Centre, Stantonbury Campus**

### **Coffee and Cake**

**Every third Saturday morning in the Month 9.30am to 11.30am**

A time for parents and carers to relax and chat

Activities for all the children

And a quiet area for reflection and peace

### **Under Fives**

**Every Thursday morning in Term Time from 9.30am to 11.30am**

A chance for parents and carers to meet and talk together

Fun activities for the children and story time.

### **Café Services**

**Every fourth Sunday in the Month a Café Service from 10.30am to 11.30am**

This is an informal service. Tables to sit around, refreshments and a choice of, sometimes challenging but always fun activities for all ages.

Children are very welcome.

The café service is an opportunity to meet others and discuss the thoughtful theme of the morning. A chance to begin to explore your thoughts and feelings about the Christian Faith with others if you wish.

**Family Services at 10.30am on the other Sundays**

### **Easter Services at Christ Church**

**Maundy Thursday 29<sup>th</sup> of March, Agape shared meal 7.00pm**

**Good Friday 30<sup>th</sup> of March 2.00pm, Service of Meditation at the Cross (at St Andrews)**

**Easter Day 1<sup>st</sup> of April 9.30am, communion followed by breakfast**

**Easter Day 1<sup>st</sup> of April 10.30am, All Age Worship Celebrating the Resurrection**

**Contact for more information Patricia 07786143900**

## BRADWELL WINDMILL

### Bradwell Windmill Open Days 2018.



**Here is the list of the days that the Bradwell Windmill will be open for 2018 the time for every date is 1.30pm to 4.30pm.**

**Sunday 29th April**

**Monday 7th May**

**Saturday 12th May - National Mills Weekend**

**Sunday 13th May - National Mills Weekend**

**Sunday 27th May**

**Sunday 24th June**

**Sunday 29th July**

**Sunday 26th August**

**Saturday 8th September - Heritage Open Days**

**Sunday 9th September - Heritage Open Days**

**Sunday 30th September**

**Sunday 28th October**

**Run by Milton Keynes Museum volunteers, Bradwell Windmill is located adjacent to the Railway Walk and Grand Union Canal and opens its doors to the public to show what life was like in a C19th mill.**

Built in 1817 from local limestone, it is one of the most unusual and important buildings in Milton Keynes. It can also be used for local community activities and events by arrangement with the Museum.

Bradwell Windmill is thought to be the second windmill built in Bradwell village, replacing an earlier post mill on the site of Summerfield School, which sat on a post in order that the whole structure could be turned so the sails caught the wind.

The mill we now see just off the V6 Grafton St was erected around 1805 and just about made a living

for the families that owned it, milling grain for local farmers. However, it was less reliable than the area's water mills, for example along the Ouse at Old Wolverton, and by the 20th century it was derelict. The Council acquired it for just £80.

Its return to health for the first time in 139 years was achieved through a partnership between the building's stewards, Milton Keynes Museum, and Milton Keynes Council. The restoration involved making the building watertight and restoring the sails and milling mechanism, so visitors can expect to see the historic millstones in action. Like the Museum itself, Bradwell Windmill is maintained and operated by volunteers.

# GET SORTED MK! - RECYCLE YOUR WASTE

**Get Sorted MK! is the new recycling campaign for Milton Keynes. Many people recycle their rubbish very well but everyone could do a little more to help make MK a greener more environmentally friendly place.**

Get Sorted MK is a new, fun and useful way to find out about how all sorts of things can be recycled, reused or repurposed from MK Council. [www.getsortedmk.co.uk](http://www.getsortedmk.co.uk)

## Get Involved!

Contamination of the recycling bags is a problem in MK and a high number of these are arriving at the Materials Recycling Factory (MRF) every week with things like food waste or dirty nappies in them which have to be picked out by hand! These can also contaminate the recyclable items inside the bag making the whole bag unsuitable for recycling.

On this website, you can find out information, get tips and advice and upload your photos for recycling in MK.

Maybe you've held a swishing (clothes swap) or been litter picking in your local area? Or maybe you've discovered a great way to repurpose a piece of furniture or old car tyre?

Being responsible for how we dispose of our rubbish means less going to landfill which is good for the city and the planet!

Are you planning an event? Tell us by emailing us at [recycleandreward@milton-keynes.gov.uk](mailto:recycleandreward@milton-keynes.gov.uk)

## Q. What is contamination?

If incorrect items are put in recycling bins, boxes or bags, the items have to be removed by hand at our Materials Recycling Factory. Items like food waste or dirty nappies inside the recycling bag could potentially contaminate the other items in the bag and make them unsuitable for recycling.

**NO FOOD WASTE IN THE BLACK BAG. IT ATTRACTS ANIMALS WHO RIP THE BAGS. USE THE GREEN BIN INSTEAD.**



### GREEN WHEELIE BIN

All food waste e.g. meat, peelings, bread, dairy, coffee grounds and tea bags. Also garden waste e.g. twigs, leaves, grass cuttings, flowers and branches.



### CLEAR SACK

Newspapers, junk mail, envelopes incl. windowed ones, aerosols, plastic bottles, trays and pots, aluminium cans and tins, food & drink cartons, clean foil and cardboard which should be fully inside the clear sack

**DO NOT put food waste, textiles or dirty nappies in here!**



### BLACK BIN BAG

plastic bags, cling film, fruit nets, nappies, animal waste like poo and bedding, broken glass or china (wrapped well) and polystyrene packaging.



### BLUE BOX

Glass jars and bottles ONLY without lids or stoppers  
No other type of glass should go in here



### YELLOW BATTERY BAG

Put your used batteries in here and place on top of green bin on your collection day



# **Calling all Skateboarders and BMX-ers and Scooter Riders WE NEED YOUR EXPERTISE!**



**We are currently looking to replace the Skate Ramp at the  
Adventure Play Park on Stantonbury.**

**This is your chance to have your say – Call in to the Parish Office  
anytime between 9.00am and 4.00pm and tell us how you wish  
your new Skate Ramp to look.**



**Thanks to the generous support we received last year, we raised an incredible £6.9 million for our vital service. We cannot thank our supporters enough for your help in reaching this record fundraising total.**

**1,191 patients attended last year**

**365 days of operation**

**We bring the hospital to the roadside**

Our successes did not stop with fundraising. Our crew won a host of awards with Dr Syed being named Doctor of the Year at the Association of Air Ambulance Awards of Excellence. Dr Oli and Paramedics Andy & Neil continued a season of success as they were awarded the 999 Person of the Year Award at the Ambies.

We will look to build on these successes in 2018 with some really exciting operational developments and a full calendar of fundraising events.

The TVAA Team



## Answers to Spring Crossword

### Across

- 4 Bluebell
- 5 Tadpole
- 7 Chick
- 8 Blossom
- 9 Pollen
- 11 Bee

### Down

- 1 Daffodil
- 2 April
- 3 Nest
- 4 Bunny
- 6 Duckling
- 10 Lamb

# Spring Crossword

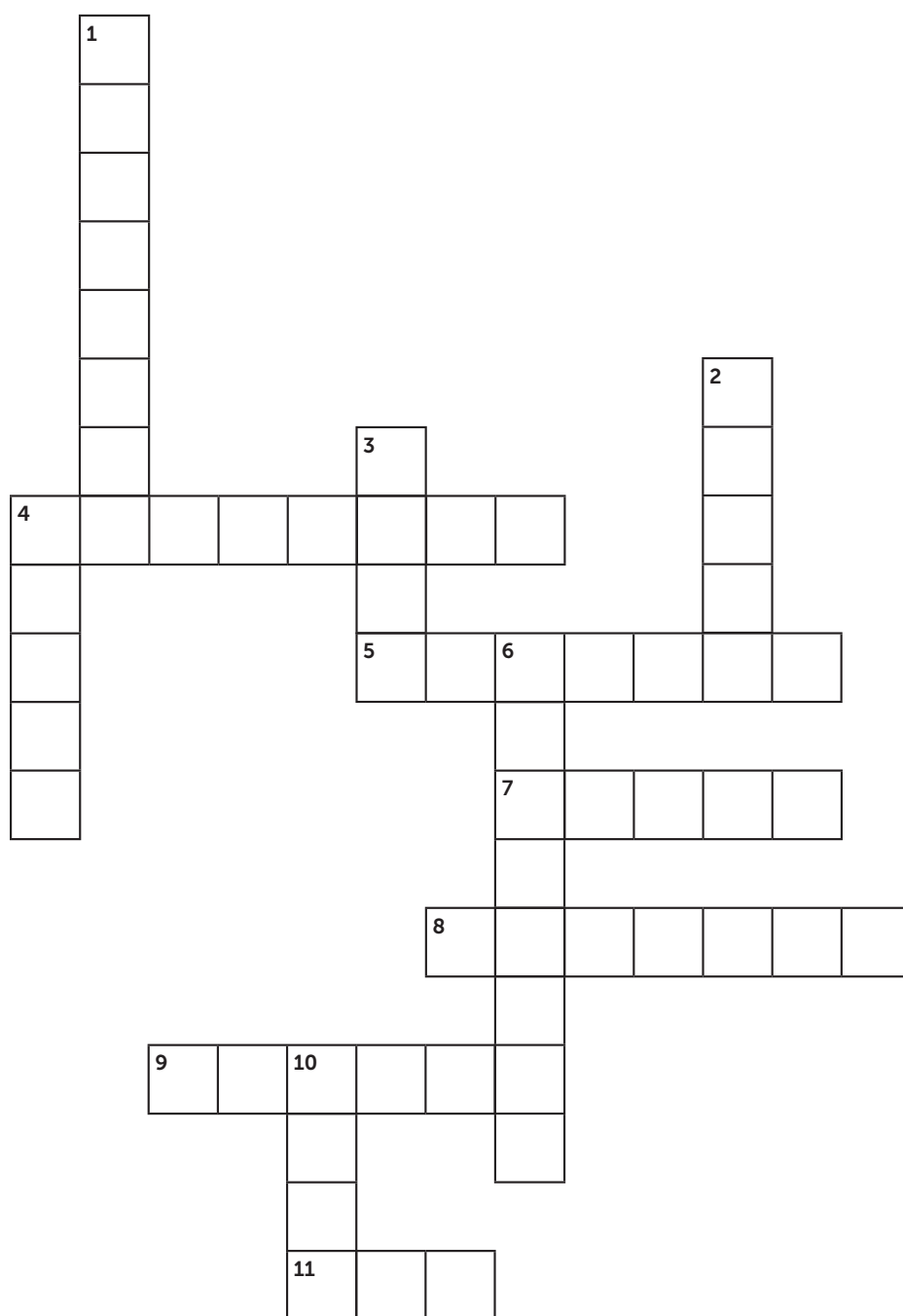

## Across

- 4 A blue woodland flower
- 5 The young of a frog or toad
- 7 A young bird about to be hatched or newly hatched
- 8 The mass of flowers on a fruit tree
- 9 A bees hind leg carries this from flower to flower
- 11 A four-winged insect which collects nectar and is often kept in a hive for its honey

## Down

- 1 A yellow spring flower
- 2 The fourth month of the year
- 3 The bed constructed by a bird for laying its eggs
- 4 Another name for a rabbit
- 6 A baby web-footed water-bird
- 10 The young of a sheep